

Building Service Shaft and Scissor Stair Walls with Hebel

Fast, flexible & affordable - time saving solutions

Ideal for service shafts and scissor stair spine walls, this bare system is fast to install and requires fewer trades on site.

Hebel PowerPanel SP ("Special Purpose") can be fixed horizontally or vertically. PowerPanel SP is 75mm thick and contains double reinforced steel (caged mesh). It is a 300mm wide tongue and groove product available in lengths up to 4800mm, fully cuttable.

Hebel PowerPanel SP can be left in its manufactured finish or simply and cheaply coated with a paint.

Hebel can supply: Panels, Angle Brackets, Adhesive (if required), Mortar, Anti-Corrosion Protection Paint, Screw Fixings and Hebel Patch (if required).

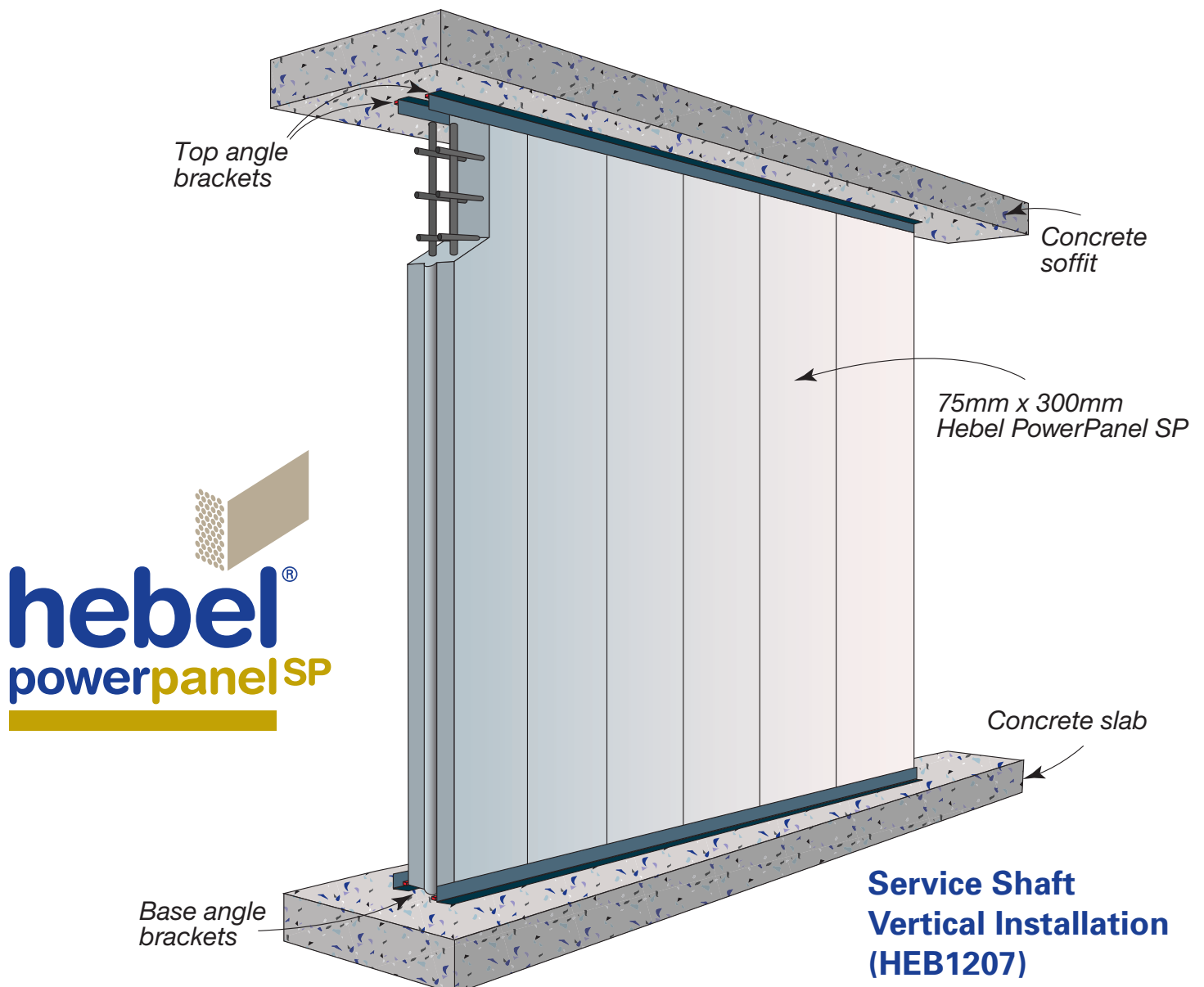

The unique benefits of building with Hebel PowerPanel SP

- Install horizontally or vertically; narrower panel is lighter and easier to handle - allows flexibility in tight access areas
- No sealant required between joints*; tongue and groove profile ensures a snug fit - save time and money
- Bare system achieves 2hr fire rating; extends BCA compliance – use Hebel in even more applications

*unless acoustic performance required

Service Shaft Horizontal Installation (HEB1206)

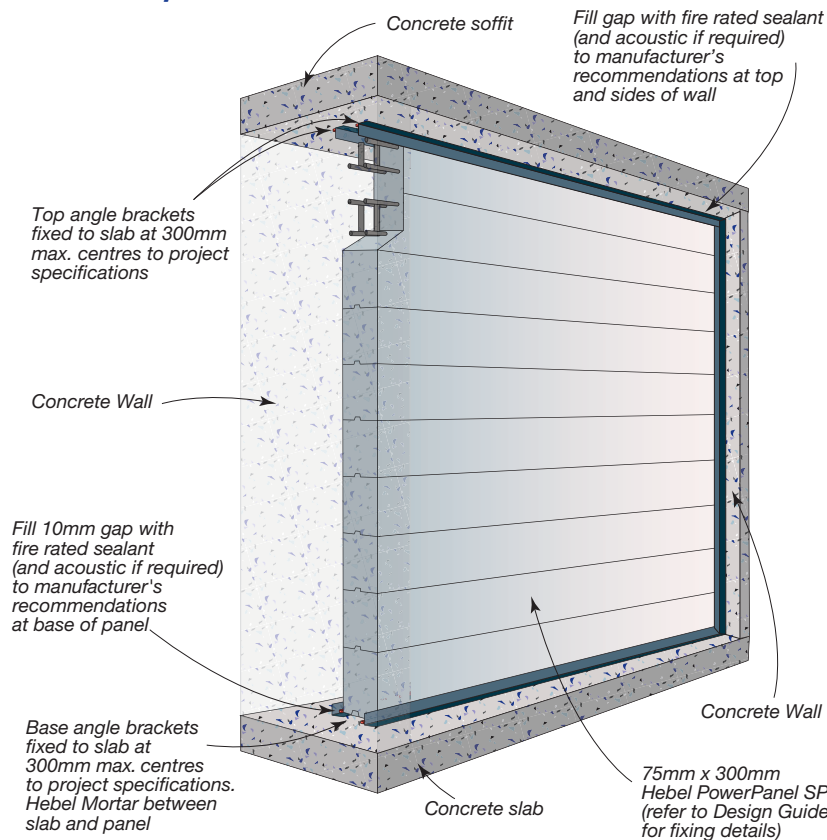

hebel[®]
powerpanel SP

PowerPanel SP System	
Installed Horizontally to max height 4800mm (HEB1206)	
Fire	-/120/120
Acoustic	R _w 36.7
Wall Thickness	75mm
Installed Vertically to max height 4650mm (HEB1207/ HEB1300)	
Fire	-/120/120
Acoustic	R _w 33
Wall Thickness	75mm

Scissor Stair Spine Wall Vertical Installation (HEB1300)

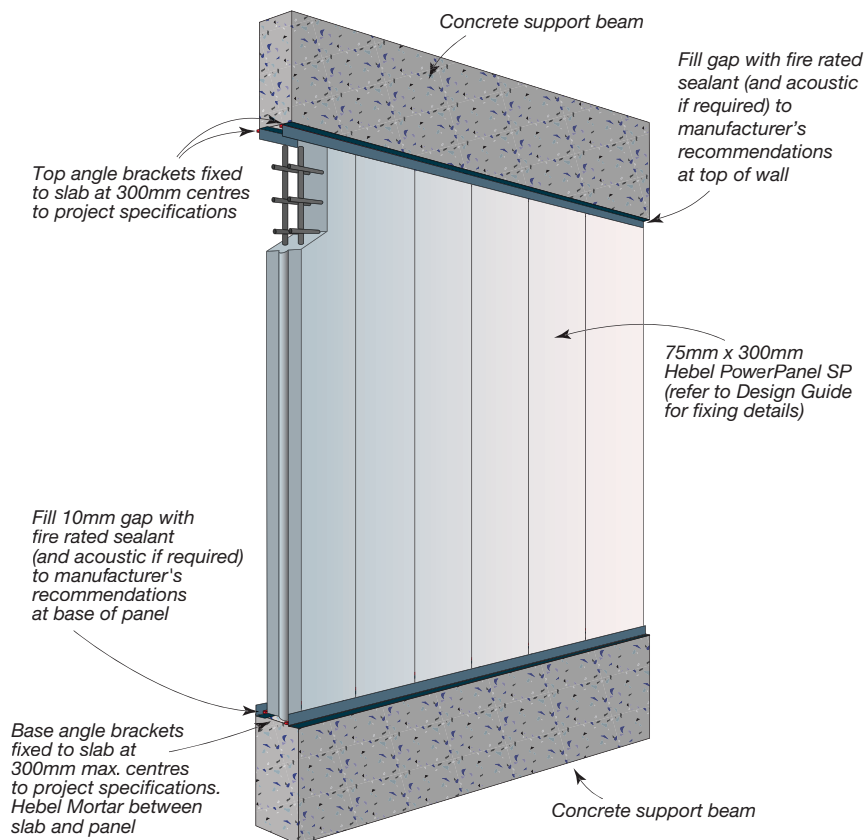

For design and installation of Hebel PowerPanel SP, refer to Hebel High Rise Multi-Residential and Commercial Service Shaft and Scissor Stair Wall Installation Guide HEB1414, or download the Guide at our website (below).

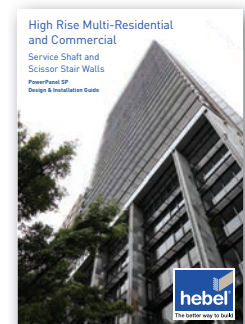

hebel[®]

The better way to build

For sales and technical enquiries call 1300 369 448 or go to www.hebelaustralia.com.au