

**RONDO®**  
**EXANGLE®**  
**Finishing Sections**

EXANGLE® installation guide

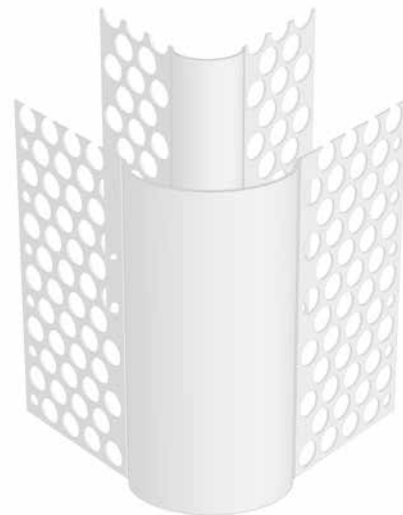

# RONDO EXANGLE

## FINISHING SECTIONS

### GENERAL INFORMATION

The Rondo EXANGLE® and EXANGLE® Render & Texture range has been developed over 45 years by Rondo's team of experienced R&D engineers and in close consultation with our customers. Our philosophy of providing our customers with only the best product design ensures that both our interior and exterior range of drywall, render and texture beads are manufactured to assist contractors in obtaining a strong, straight, knock-resistant corner with a superior finish that lasts.

Note that this brochure is intended to be used as a guide only; full details should be obtained from the Rondo website. All products in this brochure are for internal use only unless otherwise indicated. Rondo recommends installation by a qualified tradesperson and that you check you are referring to the latest edition by comparing this to the one currently available on our website, [www.rondo.com.au](http://www.rondo.com.au)

### FEATURES & BENEFITS

FEATURE	BENEFIT
<b>Code Compliance</b>	The Rondo EXANGLE® range is manufactured from steel that complies to the following standards: AS/NZS 1397:2001 Steel Sheet and Strip, and ASTM B 117 Corrosion Test. The Rondo EXANGLE® RT range also complies with AS3972-1991 Portland Blended Cement, and ASCA 27-1959 Internal Plastering on Solid Backgrounds.
<b>Written Warranty</b>	When installed correctly, Rondo EXANGLE® and EXANGLE® RT products come with a written warranty available at <a href="http://www.rondo.com.au">www.rondo.com.au</a> . So you can have peace of mind when using a Rondo product.
<b>Expansive Range</b>	Rondo produce a range of products suitable for internal drywall applications (Rondo EXANGLE®) and interior / exterior render and texture applications (Rondo EXANGLE® RT). This means that the most cost effective application may be used depending on the intended application.
<b>Quality Control</b>	All Rondo products are manufactured using state-of-the-art manufacturing processes by a manufacturer who has been in the business for over 50 years, and are produced under Quality Management System certified to ISO 9001 Standards.
<b>Technical Expertise</b>	For detailed technical information, visit <a href="http://www.rondo.com.au">www.rondo.com.au</a> to view the Rondo Professional Design Manual, view the EXANGLE® installation video, download the Rondo App, or obtain a technical resource USB from your Authorised Rondo Distributor. For all other technical advice, contact your local Rondo Technical Sales Representative.

### OTHER RONDO BUILDING BOARD AND RENDER PRODUCTS

Below are some additional products not mentioned in this guide. For Full information on these products, refer to the Rondo Professional Design Manual available from the Rondo website: [www.rondo.com.au](http://www.rondo.com.au)

#### RONDO EXANGLE® – DRYWALL FINISHING SECTIONS



#### RONDO EXANGLE® RENDER & TEXTURE FINISHING SECTIONS

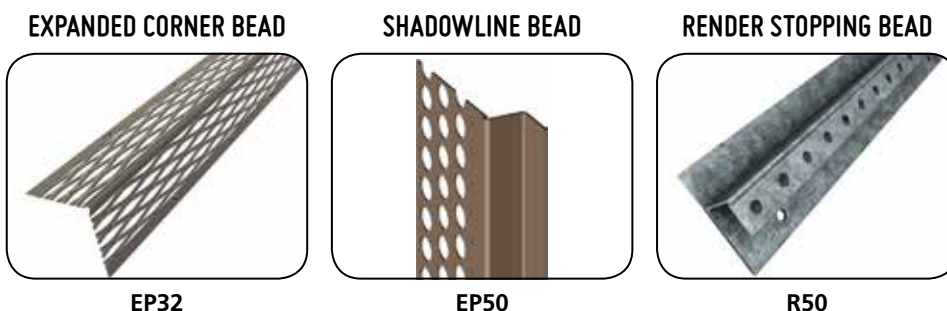

# RONDO EXANGLE

## FINISHING SECTIONS

### CORNER BEADS

90° external corner beads are available in two profiles. Use P01 for a sharper finish or P32 for a slightly more rounded corner. A 135° P01 profile, P01A, is used for splayed corners.

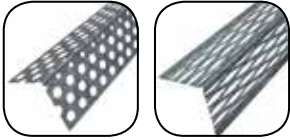

P01/P01A

P32

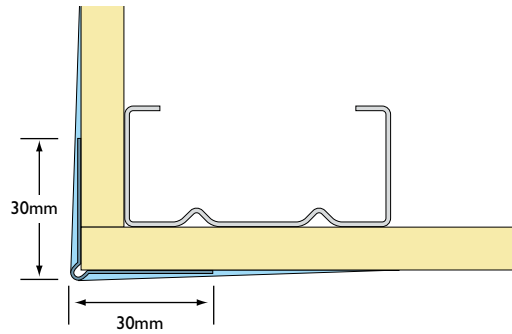

### INTERNAL CORNER BEADS

For internal 90° corners use PS17, or PSIA for internal 135° corners. Suitable for both Plasterboard and Fibre Cement, the raised centre of the bead provides a guide for the setting trowel to allow maximum penetration of setting compound.



PS17/PSIA

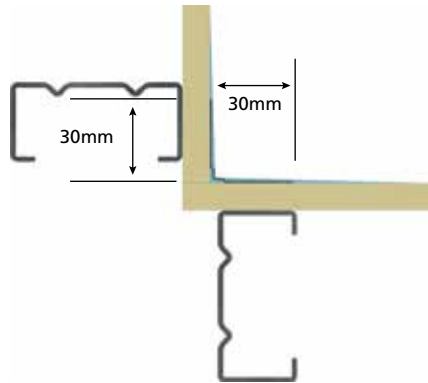

### STOPPING BEADS

Rondo Stopping Beads P11, P12, P13 & P14 can be used to fit 6, 10, 13, and 16mm boards respectively, capping the exposed end of the board.



P11/P12/P13/P14

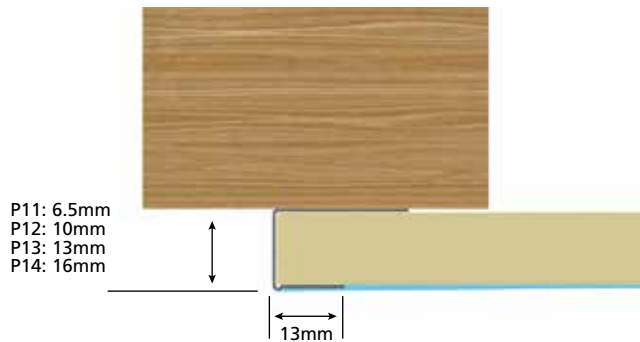

### STOPPING ANGLES

Rondo Stopping Angles P25, P26, P27 and P28 are made to suit 10, 13, 16 and 32mm boards respectively. Suitable for use in applications where the edge of the board is not exposed, such as around a door jamb.



P25/P26/P27/P28

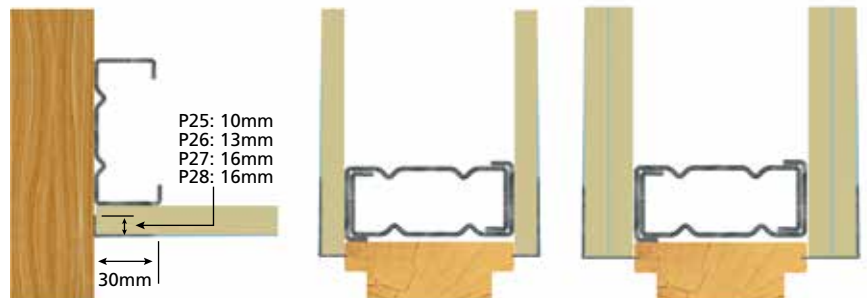

P27: DETAIL AT DOOR JAMB

P28: DETAIL AT DOOR JAMB

### SHADOWLINE STOPPING ANGLES

Shadowline Stopping Angles produce a recessed feature which also minimises problems caused by misaligned wall and ceiling junctions. Available in two profiles; the P50 to allow a 10x10mm recess, up to 16mm board; and the P60 which gives a 6x10mm recess and is suitable for 6mm board.



P50/P60

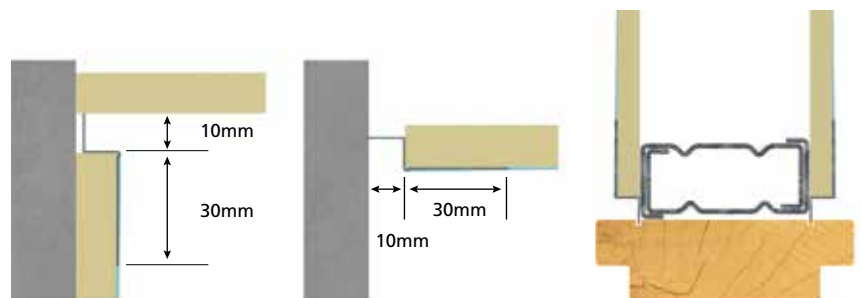

DETAIL AT DOOR JAMB

## CONTROL JOINTS

Suitable for use in both walls and ceilings, the P35 is approved for use in fire-rated environments. It is also recommended for use where dissimilar building materials are joined to cater for differential movement.

### INSTALLATION:

- Allow a maximum 20mm gap between the boards and ensure a complete break in any framing behind the joint.
- Locate the P35 centrally in the gap and fasten the flanges to the boards at maximum of 150mm centres.
- Apply setting compound over the beads and finish the joint normally.
- When the joint is dry remove the protective tape ready for painting.

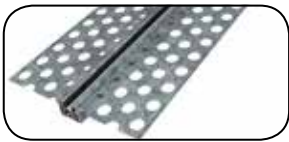

P35

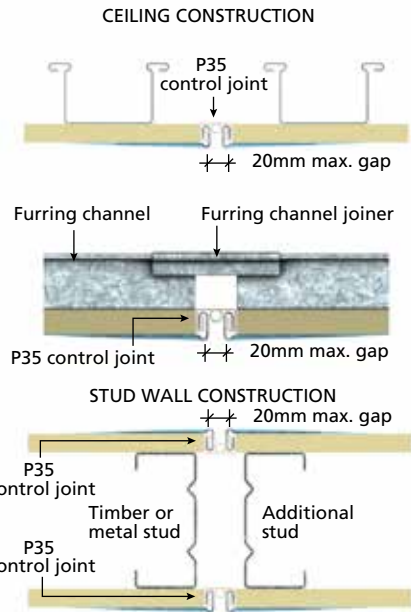
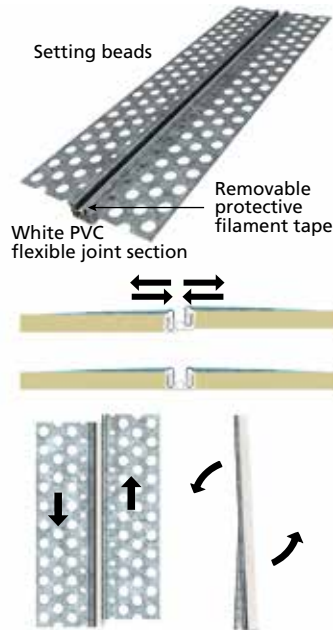

## ARCH BEAD

Rondo P10 is suitable for use in archways to produce a seamless, professionally finished, arched corner.

### INSTALLATION:

- Fit the short perforated leg of the bead to the face of the wall.
- Carefully bend the bead to suit the arch profile
- Extend arch bead 150mm below Springing Line as shown in the image featured right, then continue with corner bead along the vertical straight.



P10

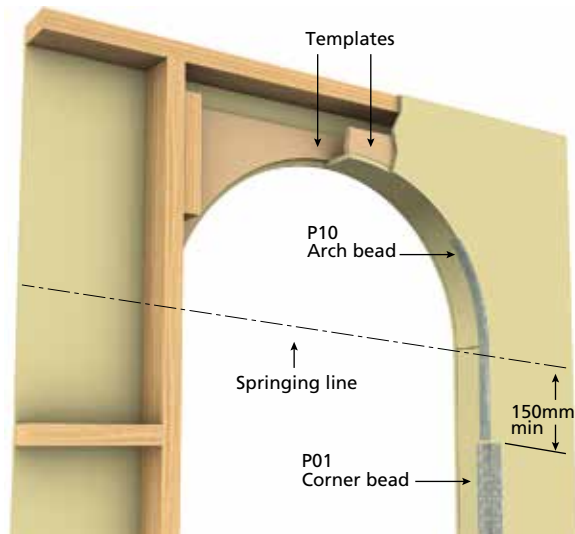

## P40 INTERNAL STABILISING ANGLE

Australian Standard AS3740–2010 (*Waterproofing of Wet Areas within Residential Buildings*), requires an internal corner section with a minimum 40mm width either side of a board junction in wet areas. The Rondo EXANGLE® P40 Internal Stabilising Angle should be fixed to timber framed junctions in wet areas at a minimum of 1800mm above the floor level to provide support behind the lining board corner junction.



P40

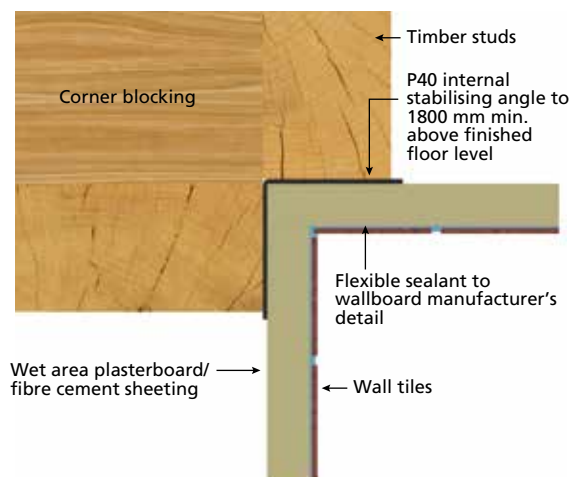

**RENDERLOCK CORNER BEADS**

R01 & R02 corner beads are suitable for internal render finishes.

The R01 has 55mm legs suitable for up to 10mm thick render and a 4.5mm nib.

The R02 has 60mm legs suitable for up to 25mm thick render, and a 2.5mm nib which is particularly useful where variations in prestressed concrete and preformed corners require realignment.

NOTE: For external applications, use SR02.

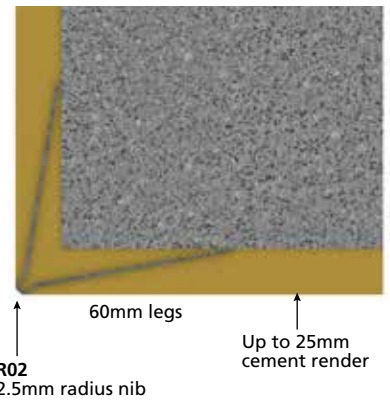
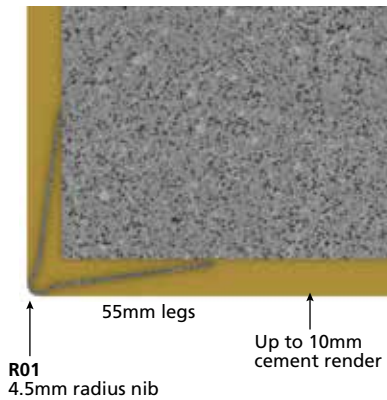

**STOPPING BEADS**

The R11 Stopping Bead provides a clean end to 10mm render where it is not bonding into another substrate. The perforated legs ensure the render holds firmly to the bead to prevent any breakaway.

**CONTROL JOINTS FOR RENDER**

The R11 can also be used to create Control Joints in render to render situations and render to other substrates. The diagrams featured right show how to achieve the required joint between the varying substrates using the R11 Stopping Bead and flexible caulking compounds.

NOTE: For external applications, use ER11.

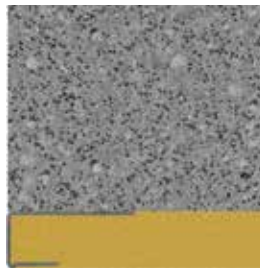
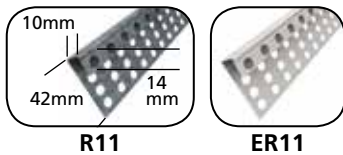

R11 DETAIL

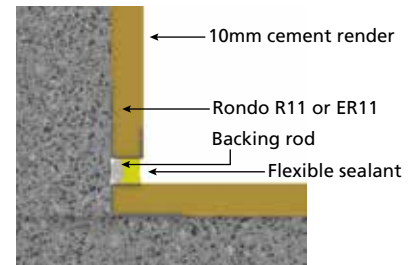

CONTROL JOINT CORNER DETAIL

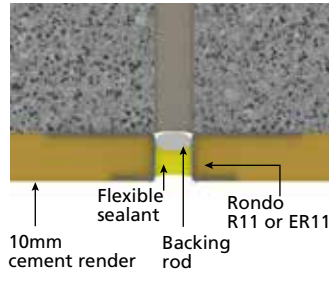

CONTROL JOINT: RENDER

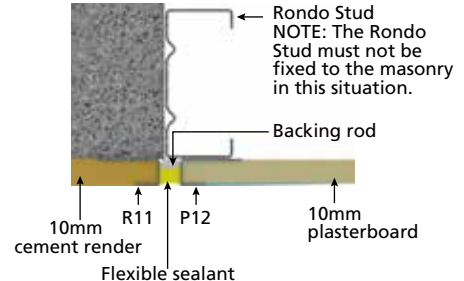

CONTROL JOINT: RENDER/PLASTERBOARD

**STOPPING BEAD FOR BLUE BOARD TYPE CLADDING**

The EP17 perforated stopping bead may be used as an edge-capping on 7.5 and 8mm fibre cement board such as Blue Board type products. It also provides a neat starter or finishing strip to the texture coat applied to the board. The EP17 is suitable for use in exterior applications, however it is recommended to download the Rondo Warranty or the full Rondo Professional Design Manual for full terms and conditions along with instructions for use.

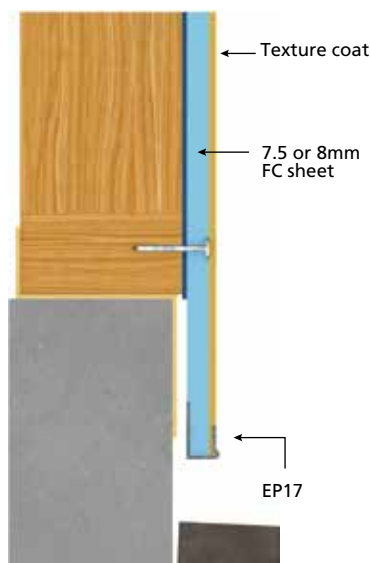

NOTE: This brochure is intended to be used as a guide only; full details should be obtained from the Rondo website. Rondo recommends installation by a qualified tradesperson. For all products used externally, visit [www.rondo.com.au](http://www.rondo.com.au) to download the Rondo Professional Design Manual for correct installation guidelines, or view the Rondo Warranty terms and conditions. For all other advice, speak to your local Authorised Rondo Distributor.



# RONDO OFFICES

**AUSTRALIA: RONDO BUILDING SERVICES PTY LTD**  
CUSTOMER SERVICE HOTLINE: 1300-36-RONDO (1300-36-7663)

**NEW SOUTH WALES**  
57-87 Lockwood Road Erskine Park NSW 2759  
(PO Box 324 St Marys NSW 1790)  
phone: 61-2-9912 7300 fax: 61-2-9912 7310 email: [nsw@rondo.com.au](mailto:nsw@rondo.com.au)

**VICTORIA**  
12-14 Dunlop Road Mulgrave VIC 3170  
(Private Bag 23 Mulgrave VIC 3170)  
phone: 61-3-8561 2222 fax: 61-3-8561 2266 email: [vic@rondo.com.au](mailto:vic@rondo.com.au)

**QUEENSLAND**  
13 Binary Street Yatala QLD 4207  
(PO Box 6006 Yatala QLD 4207)  
phone: 61-7-3442 6400 fax: 61-7-3442 6427 email: [qld@rondo.com.au](mailto:qld@rondo.com.au)

**SOUTH AUSTRALIA**  
39 George Street Green Fields SA 5107  
phone: 61-8-8256 5900 fax: 61-8-8256 5922 email: [sa@rondo.com.au](mailto:sa@rondo.com.au)

**WESTERN AUSTRALIA**  
5 Hazelhurst Street Kewdale WA 6105  
(PO Box 168 Cloverdale WA 6985)  
phone: 61-8-9251 9400 fax: 61-8-9251 9414 email: [wa@rondo.com.au](mailto:wa@rondo.com.au)

**HEAD OFFICE**  
57-87 Lockwood Road Erskine Park NSW 2759  
(PO Box 324 St Marys NSW 1790)  
phone: 61-2-9912 7300 fax: 61-2-9912 7310 email: [rondo@rondo.com.au](mailto:rondo@rondo.com.au)

**EXPORT** phone: 61-438-427-479 fax: 61-7-3287-1881 email: [export@rondo.com.au](mailto:export@rondo.com.au)

**NEW ZEALAND: RONDO BUILDING SERVICES PTY LTD**  
FREE CALL: 0800-0800-RONDO (0800-0800-76)  
[www.rondo.co.nz](http://www.rondo.co.nz)

**AUCKLAND**  
117 Captain Springs Road Onehunga  
Auckland 1061  
(PO Box 12464 Penrose Auckland 1642)  
phone: 64-9-636 5110 fax: 64-9-636 5111 email: [rondo.newzealand@rondo.co.nz](mailto:rondo.newzealand@rondo.co.nz)

**CHRISTCHURCH**  
106 F Carmen Road Hornby Christchurch 8042  
phone: 64-3-421 7840 fax: 64-9-636 5111

**MALAYSIA: RONDO METAL PRODUCTS SDN BHD**  
Lot 606, off Jalan SS13/1K  
47500 Subang Jaya Selangor  
phone: 60-3-5636 0710 fax: 60-3-5636 0711 email: [rondo.malaysia@rondo.com.my](mailto:rondo.malaysia@rondo.com.my)  
[www.rondo.asia](http://www.rondo.asia)

**UAE: RONDO METAL PRODUCTS SDN BHD**  
Al Saraya Avenue Building Al Garhoud Dubai UAE  
(PO Box 14424 Dubai UAE)  
phone: 971-505-511-893

**INDIA: RONDO METAL SYSTEMS PVT LTD**  
Plot J-21, MIDC Talaja, Tal, Panvel  
Dist Raigad - 410 208 Mumbai India  
phone: 91-22-2740 2831 email: [rondo.india@rondo.co.in](mailto:rondo.india@rondo.co.in)  
[www.rondo.co.in](http://www.rondo.co.in)

# RONDO®

[www.rondo.com.au](http://www.rondo.com.au)