

Building Service Shaft and Scissor Stair Walls with Hebel

Fast, flexible & affordable - time saving solutions

Ideal for service shafts and scissor stair spine walls, this bare system is fast to install and requires fewer trades on site.

Hebel PowerPanel SP ("Special Purpose") can be fixed horizontally or vertically. PowerPanel SP is 75mm thick and contains double reinforced steel (caged mesh). It is a 300mm wide tongue and groove product available in lengths up to 4800mm, fully cuttable. Hebel PowerPanel SP can be left in its manufactured finish or simply and cheaply coated with a paint.

Hebel can supply: Panels, Angle Brackets, Adhesive (if required), Mortar, Anti-Corrosion Protection Paint, Screw Fixings and Hebel Patch (if required).

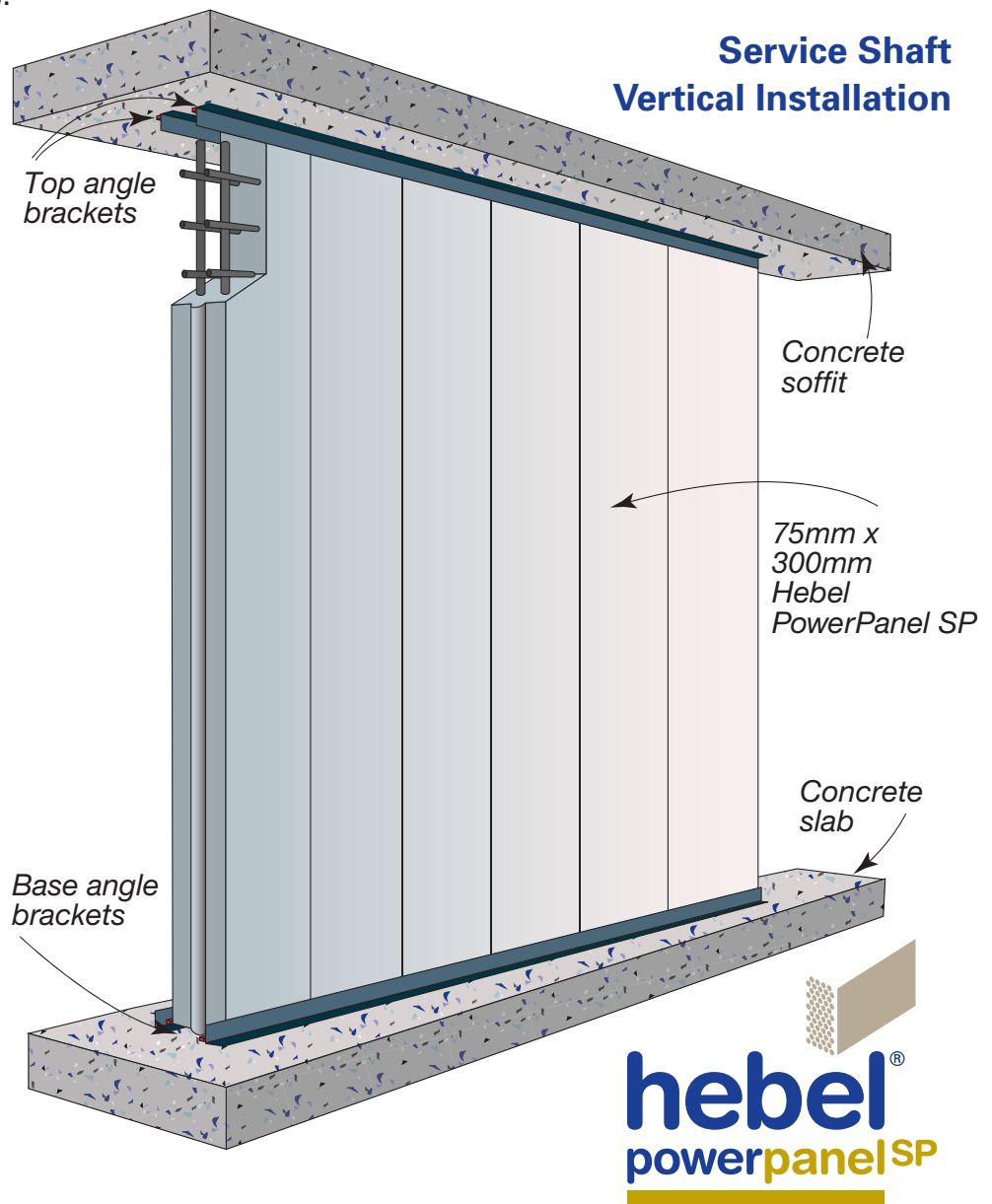
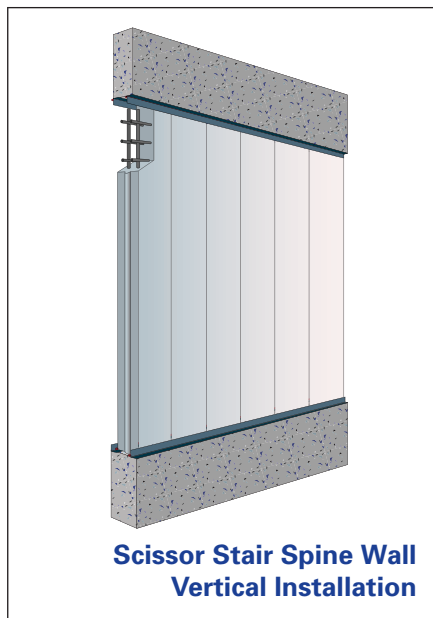
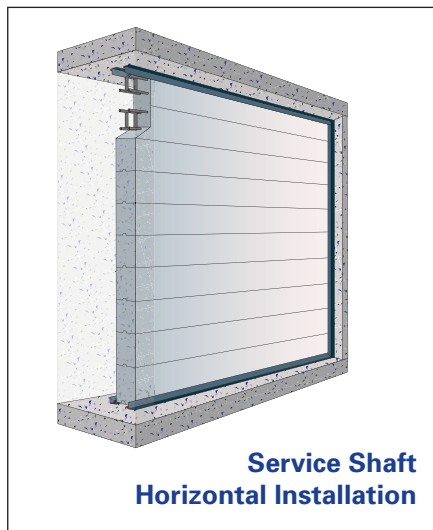

The unique benefits of building with Hebel PowerPanel SP

- Install horizontally or vertically; narrower panel is lighter and easier to handle - allows flexibility in tight access areas
- No sealant required between joints*; tongue and groove profile ensures a snug fit - save time and money
- Bare system achieves 2hr fire rating; extends BCA compliance – use Hebel in even more applications

*unless acoustic performance required

Better buildings are constructed with Hebel

Hebel PowerPanel SP:

- **A high-performance lightweight concrete panel system.**
- **Proven, scientifically tested and trusted by leading builders.**
- **Australian made and backed by CSR**

What is Hebel?

Hebel is high performance lightweight aerated concrete manufactured from sand, cement, recycled material, lime, gypsum and aerating agents.



Hebel PowerPanel SP

Build with confidence and peace-of-mind



The unique attributes that make Hebel such an innovative, sustainable and proven building product are perfectly summarised by the following qualities:



Faster construction period

Hebel internal wall systems are fast to construct and require significantly less labour compared to traditional masonry construction techniques. Building with Hebel results in savings, less mess on-site, a cleaner, safer work area and less clean-up at completion of building.



Fire resistant for compliance, added security and peace of mind

Hebel is non-combustible and renowned for its highly fire resistant properties. PowerPanel SP achieves a fire rating (FRL) of -/120/120 which satisfies and in some cases exceeds BCA requirements for non-load bearing internal walls.



Lightweight yet solid and tough as masonry

Hebel PowerPanel ensures lighter loads on structures compared to traditional masonry. This can lead to substantial savings in supportive concrete floors in multi-storey developments.



A sound reason for better acoustic qualities

Hebel pioneered the introduction of lightweight wall panels providing acoustic performance levels at or above $R_w + C_{tr} = 50$ in high rise multi-residential buildings.



A comforting thought for a comfortable living environment

Hebel's unique AAC construction provides superior insulation qualities for a masonry product. The unique combination of thermal resistance, along with thermal mass, makes building with Hebel a smart choice for meeting Australia's increasing building efficiency regulations.



Sustainability for a better world in the long term starts today

Hebel delivers a diverse number of environmental benefits over brick and concrete.

Hebel uses 61% and 64% less embodied energy and 64% and 55% less greenhouse gas emissions than the comparative products, concrete and brick veneer respectively.

For further information or to speak with a Hebel expert call:

1300 369 448

www.hebelaustralia.com.au



The better way to build